

Link to the product: <https://stair-lighting.com/profile-regulor-kpl-anodized-aluminum-lens-cover-p-644.html>



Profile REGULOR-KPL - Anodized aluminum lens cover

Price	9.23 Euro
Availability	Available
Shipping time	3 days
Number	644
Manufacturer	KLUS

Product description

Important Information

The purchase a piece in the store means the purchase 1 linear meter of the profile or cover

If you want to buy a profile that has a length of 2 meters you have to buy 2 pieces, 3 meters you have to buy 3 pieces, and the multitude of quantity when ordering.

The total length of the aluminum profile or the panel to the profile - is the total quantity of the piece number that was bought in the store.

The choice of the appropriate shipping method will take place at the end of the order process.

[The details of the shipping method and packaging of the aluminum profiles you will find here \(click in the link\)](#)

Profile REGULOR - Anodized aluminum lens cover 1m (choice in accessories)

The product you have selected contains only - aluminum profile - does not include the accessories located in the Accessories tab.

Additional accessories like covers, end caps, electricity conductive end cap, mounting bracket, fasteners, mounting springs, proximity switch, micro switch, mounting system and others are available under "Accessories".

If you are interested in longer lengths than one meter, write to us we will quote the delivery cost to you. Transport companies expect additional charges for long shipments.

For each country is different maximum length of the profile that we can send. It does not depend on us only by courier.

We also do service cutting aluminum profiles to the indicated size - write or call get comprehensive information.

Profile uniwersalne do montażu na powierzchni, wbudowania lub podwieszenia /
Universalprofile zur Aufputz-, Unterputzmontage oder zum Abhängen

REGULOR

REF. B468+43



Ruchoma wkładka dla LED dająca możliwość wyboru jednego z czterech kątów świecenia: 10, 30, 60 i 90 stopni.

PRZEZNACZENIE PRODUKTU:

- profil do budowy opraw powierzchniowych dających skupiony strumień światła. Regulacja ustawienia wkładki umożliwia osiągnięcie kątów rozsyłu 10, 30, 60 i 90 stopni.

MONTAŻ:

- za pomocą wkrętów odpowiednio dobranych do podłoża,
- za pomocą mocowników,
- za pomocą akcesoriów do podwieszeń,
- za pomocą klejów montażowych.

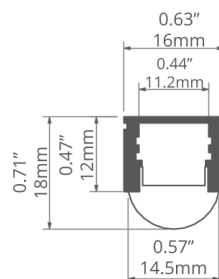

Bewegliche Einlage für LEDs ermöglicht 4 Leuchtwinkel von: 10, 30, 60 und 90 Grad.

ANWENDUNG

- ein Profil für den Bau von Aufputz-Leuchten mit fokussiertem Lichtstrahl. Durch Justierung der Einlage kann ein Abstrahlwinkel von 10, 30, 60 und 90 Grad erreicht werden

MONTAGE

- mit Schrauben angepaßt an den angepaßt
- mit Befestigungsclips
- mit Abhängezubehör
- mit Montagekleber

profil / Profil

długość / Länge	szerokość LED / LED-Breite	wykończenie powierzchni / Oberfläche	numer artykułu / Artikelnummer
1 m	10 mm	● Srebrny anodowany / Silber eloxiert	B468+43ANODA_1
2 m			B468+43ANODA_2
3 m			B468+43ANODA_3

akcesoria / Zubehör

osłony przezroczyste / transparente Abdeckungen	mocowniki / Befestigungsclips	zawieszki / Befestigungen	głowice / Köpfe
S 00220	PDS-STN 24190	PUSZ-LIN-MR 42258	BZP 42213
satin covers / Satinabdeckung	PDS 24189	PUSZ-PRET-MR 42252	BZP-ZO 42214
	PDS 24223	DP 00644	BZP-ZZ 42218
S 17111	PD-MICRO 42150	DP-MOC 00645	ST 42216
zaślepki szare / graue Endkappen	PL-PDM 24041	DP-MOC-ZO 00646	ZO 42217
	REG-PD-UV 24270	DP-MOC-ZZ 00647	ZZ 42218
REGULOR 00310	zestawy mocowań / Befestigungssätze	DP-ZO 00649	
REGULOR-OTW 00313		DP-ZZ 00651	
sprężyny mocujące / Befestigungsfedern	RG-1 42647		
	RG-1 42648		
PDS 00800			

Universal Extrusions for surface mount, recessed or suspended applications /
Perfiles universales para aplicaciones de montaje en superficie, empotradas o suspendidas

REGULOR

REF. B468+43

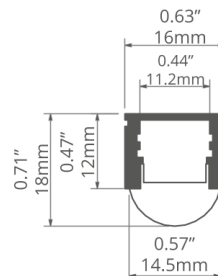

A movable insert for LEDs enabling four different lighting angles.

APPLICATION

- extrusion for construction of surface mounted fixtures with a focused beam of light.

ASSEMBLY

- with screws appropriately selected for the surface.
- with mounting brackets.
- with suspension accessories.
- with mounting adhesives.

ADDITIONAL INFORMATION

- the insert setting adjustment enables 10°, 30°, 60° and 90° beam angles.



Un inserto móvil para LED que permite cuatro ángulos de iluminación diferentes.

APLICACIÓN

- perfil para la construcción de luminarias montados en superficie con un haz de luz enfocado.

MONTAJE

- con tornillos adecuadamente seleccionados para la superficie.
- con soportes de montaje.
- con accesorios de suspensión.
- con adhesivos de montaje.

INFORMACIÓN ADICIONAL

- el inserto ajustable permite ángulos de haz de 10°, 30°, 60° y 90°.

extrusion / perfil

length / longitud	space for LED strip / espacio para tira de LED	surface finish / terminado de superficie	reference number / número de artículo
39.4" / 1 m	0.39" / 10 mm	● Silver anodized / Ánodo de plata	B468+43ANODA_1
78.7" / 2 m			B468+43ANODA_2
118" / 3 m			B468+43ANODA_3

accessories / accesorios

clear covers / difusores transparentes	mounting brackets / soporte de montaje	fasteners / soportes	heads / cabezales
S 00220	PDS-STN 24190	PUSZ-LIN-MR 42258	BZP 42213
satin covers / difusores satin	PDS 24189	PUSZ-PRET-MR 42252	BZP-ZO 42214
	PDS 24223	DP 00644	BZP-ZZ 42218
S 17111	PD-MICRO 42150	DP-MOC 00645	ST 42216
grey end caps / tapas finales gris	PL-PDM 24041	DP-MOC-ZO 00646	ZO 42217
	REG-PD-UV 24270	DP-MOC-ZZ 00647	ZZ 42218
REGULOR 00310	mounting sets / sets de montaje	DP-ZO 00649	
REGULOR-OTW 00313		DP-ZZ 00651	
mounting springs / resortes de montaje	RG-1 42647		
	RG-1 42648		
PDS 00800			

Profile LED REGULOR was produced from high-quality aluminum which has been anodized. Anodizing is an additional process of electrolytic production of the oxide layer on the aluminum surface, which yields a hard matte - silver coating in shades of satin, which perfectly protects the profile against corrosion processes and all kinds of mechanical damage. Additionally, satin coating acts as decorative, so that the profile is visually nice and pleasant to the touch.

You can choose the version of the non-anodized profile, that is, raw, without additional oxidation process. Profile LED REGULOR non-anodized is used everywhere where there is no risk of mechanical damage and where the profile will not be exposed to corrosion processes, as well as where the profile will not be exposed to visual exposure and no one will touch contact with the product.

Most REGULOR LED profile is used to illuminate and highlight all kinds of tape-based LED. With it you can illuminate the elements of interior design (furniture, building, kitchens, stairs, exhibitions, stage design, advertising, hotels, workplaces), and other hard to reach and shady spots. You have to bear in mind that this profile without prior preparation is not waterproof. Non-anodized version is suitable for indoor lighting, and anodized version works during outdoor lighting.

Profile is dedicated to a special casing type cover (optional version milky or transparent), available in two standard lengths ranging 1m and 2m. These casings have large proven and certified to use the advantage that it is not obstructing during pressing. This is extremely important when mounting them. You do not have to push and just gently mounted on the so-called. "Click". This advantage will be appreciated by anyone who appreciates your time. It is worth noting that the difference in cost is really low, and the advantage is not to compare with other products on the market, which are copies of our products.

Fixing profile is done using double-sided adhesive tape, making it quick and easy to carry. At the end of the profile is recommended to put the appropriately fitting the plastic cap that will protect the profile against the ingress of dust into it, dust and unwanted solids, which would lead to soil profile and thus to the deterioration of its light parameters. Both caps and double-sided tape without any problem can be found on our website under "Accessories".

We invite you to familiarize yourself with our offer.

To benefit from the purchase price is given in accordance with the description in the auction title. We reserve the right to refuse to sell below a certain amount or charge prices commensurate to the proposed project.

Feel free to contact - biuro@illuminations.pl for additional discounts on bulk purchases.

Product Description:

- anodized aluminum - in the secondary in the electrolytic production of the oxide layer formed on the aluminum surface hard coating in the shade of matt satin silver, including to:

- Protection against corrosion and mechanical damage,
- Decorative - important when using a visual or touch.

- non-anodized aluminum - raw, without additional oxidation process used anywhere where there is a risk of scratches and the need for visual exposure and touch contact with the product.

Accessories:

- The shell of a Diffuser: milk / transparent; standard lengths: 1m, 2m - caps have the advantage of tried and proven in use, do not cause problems during insertion. It is important that you do not have to push, and just "wklikać". Acknowledges that any installer who values your time and the client. The difference in cost is low and the advantage is not to compare the products on the market, each having a copy in most of our products.

- Mounting: brackets for, double-sided tape (accessories)

- Ending: Plastic plug (accessory)

- Certificate: CE

- Patent rights

Purpose:

- for lighting and illumination using LED strips,
- interior design, furniture (building, kitchens, furniture, stairs, exhibiting (displays), set design, advertising, hotels, work stations (it is available, shaded areas) such as LED lighting stairs
- pre-treatment of the profile is not waterproof, depending on the galvanizing process can be used externally (anodized) internally (non-anodized)

Advantages:

- Small size, excellent heat dissipation, easy installation, light weight, environmentally friendly product

REGULOR-KPL

PL / Profil służy do budowy opraw oświetleniowych dających **strumień światła o wybranym kącie świecenia: 10, 30, 60 i 90 stopni.**

EN / The extrusion is used to construct lighting fixtures that provide a light stream of selected **lighting angles: 10, 30, 60 and 90 degrees.**

DE / Das Profil dient zum Bau von Leuchten, die einen Lichtstrahl mit einem gewählten **Leuchtwinkel von: 10, 30, 60 und 90 Grad** ermöglichen.

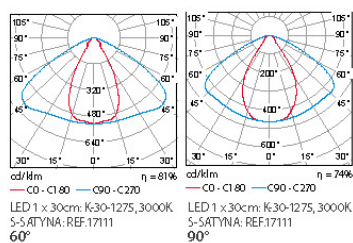
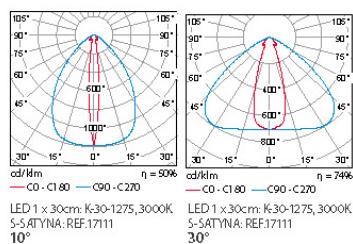
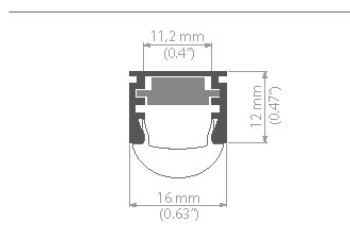

REGULOR-KPL

dlugość length Länge	szerokość paska LED LED strip width Breite LED Band	wykończenie powierzchni surface finish Oberfläche	numer artykułu article number Artikelnummer
1m (standard) 2m (standard) 3m (standard) 3 - 6m *	1 x LED strip max. 10,8 mm	● anodowany / anodized / eloxiert	B468+43ANODA





* Na specjalne zamówienie / Special order / Sonderbestellung.

akcesoria / accessories / zubehör



OSŁONKI / COVERS / ABDECKUNGEN

	S	osłona skupiająca światło / light focusing cover / lichtzentrierende Abdeckung	1m, 2m, 3m (standard)	PC	przezroczysta / transparent	00220
	S-SATYNA	osłona skupiająca światło, pasuje do zaślepek REGULOR / light focusing cover / lichtzentrierende Abdeckung	1m, 2m, 3m (standard)	PC	satyna / satin / satin	17111

REGULOR - ZASLEPKI / END CAP / ENDKAPPEN

	REGULOR	zaślepka podstawowa / basic end cap / Endkappe	PP		jasno szara / light gray / hellgrau	00310
	REGULOR	zaślepka z otworem / end cap with hole / Endkappe mit Kabelausgang	PP		jasno szara / light gray / hellgrau	00313

AKCESORIA MONTAŻOWE / MOUNTING ACCESSORIES / MOUNTING ACCESSORIES

	PDS-STN				stal sprężynowa, nierdzewna / spring steel, stainless steel / Federstahl, Edelstahl	24190
	-	mocownik / mounting bracket / Befestigungsclip			ocynk / zinc / verzinkt	1072
	-				chrom mat. / chrome matte / matt verchromt	1345
	PL-PDM	mocownik / mounting bracket / Befestigungsclip	PP			24041
	REG-PD	mocownik z regulacją / mounting bracket with beam angle regulation / Befestigungsclip, einstellung des Leuchtwinkels	PP, elementy metalowe / PP, metallic elements / PP, Metallelemente			24154

REGULO R-KPL

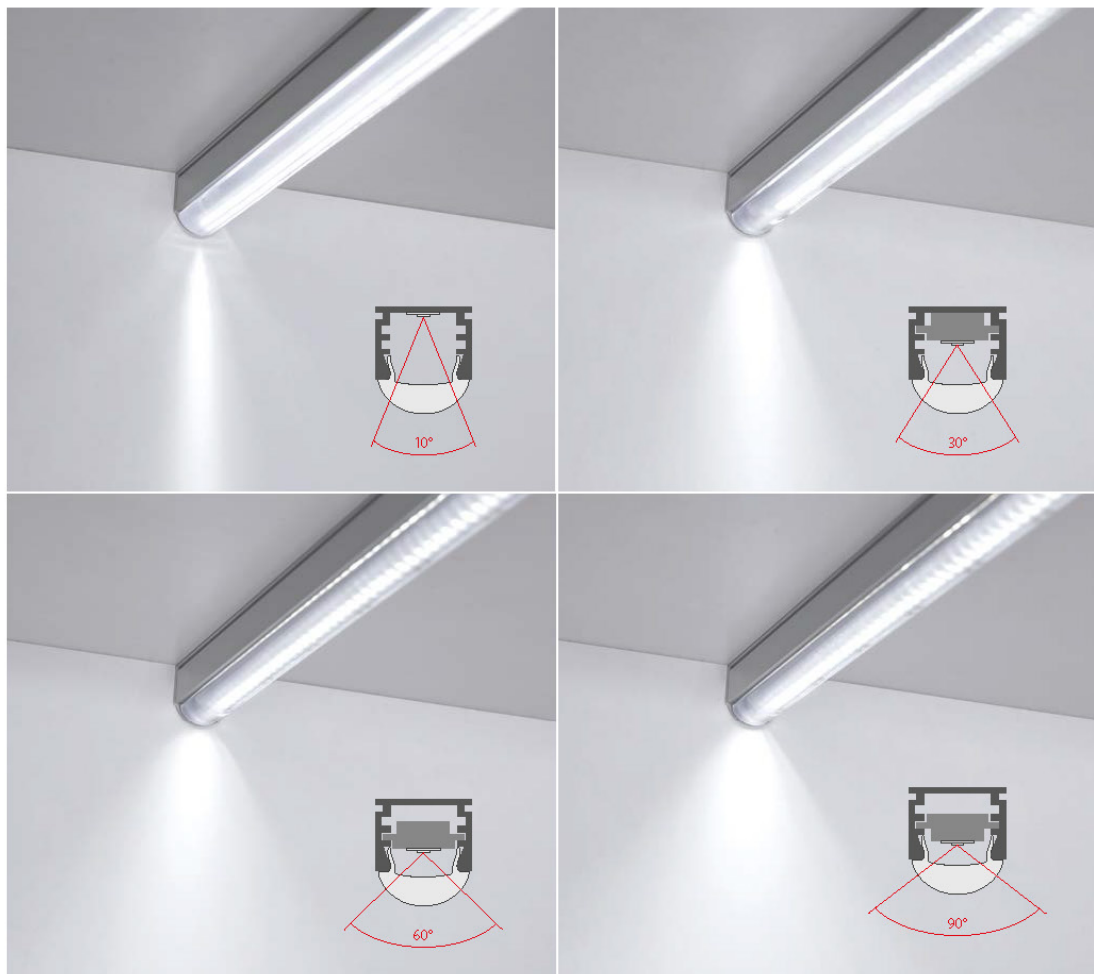

CZTERY KĄTY ŚWIECENIA

Odpowiedni kąt świecenia uzyskujemy dzięki zastosowaniu osłonki soczewkowej typu S i regulacji ruchomej wkładki wewnątrz profilu. Spełnienie tych dwóch warunków pozwala na uzyskanie następujących kątów świecenia: 10° (bez wkładki) oraz 30°, 60° lub 90° (w zależności od położenia wkładki).

FOUR ANGLES OF LIGHT

The appropriate lighting angle is obtained with the application of S type lens cover and adjustment of a movable insert inside the extrusion. Meeting these two conditions allows for obtaining the following lighting angles: 10° (without the insert) and 30°, 60° or 90° (depending on the position of the insert).

VIER LEUCHTWINKEL

Der entsprechende Leuchtwinkel wird durch Anwendung von Linienabdeckung Typ S und Einstellung der beweglichen Einlage im Inneren des Profils. Die Erfüllung der beiden Bedingungen erlaubt den Erhalt von folgenden Leuchtwinkeln: 10° (Einlage) und 30°, 60° oder 90° (je nach Positionierung der Einlage).

REGULOR-KPL

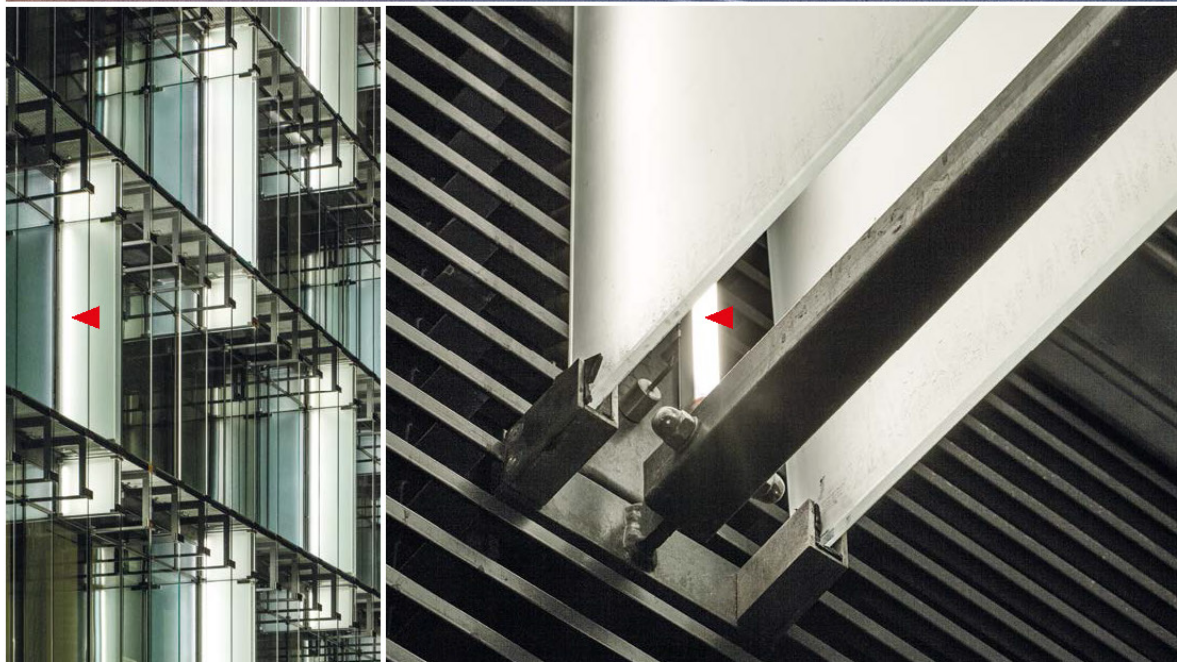

REGULOR ZWK Cztery kąty świecenia Four angles of illumination Vier Abstrahlwinkel 34



REGULOR ZWK PROFIL	długość length Länge	szerokość paska LED LED strip width Breite LED Band	wykończenie powierzchni surface finish Oberfläche	numer artykułu article number Artikelnummer
	1m (standard) 2m (standard) 3m * 3 - 6m **	1 x LED strip max. 10,8 mm	anodowany anodized eloxiert	B468+43

możliwość uzyskania poziomu szczelności IP 67 / IP 67 waterproof level can be achieved / Sonderanfertigung: wasserdicht bis IP67

OSŁONKA / COVER / ABDECKUNG / ABDECKUNG

S				
	1m (standard) 2m (standard) 3m *	przezroczysta transparent	osłonka skupiająca światło light focusing cover lichtzentrierende Abdeckung	00220

REGULOR- ZAŚLEPKI / END CAPS / ENDKAPPEN

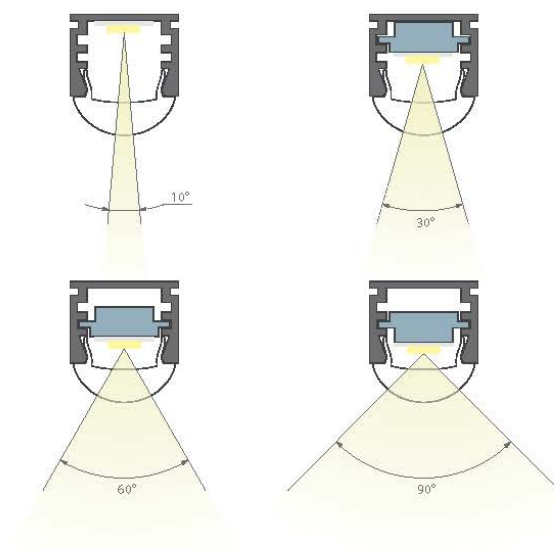

LED Profile

* Dostępne po uzgodnieniu z działem handlowym / Available by arrangement with sales department /
verfügbar nach Absprache mit dem Vertrieb.
** Na specjalne zamówienie / Special order / Sonderbestellung.



REGULOR ZWK

53

OSŁONKA - K ABDECKUNG - K COVER - K	długość Länge length	osłonka Abdeckung cover	wykończenie powierzchni Oberflächenveredelung surface finishing	numer artykułu Artikelnummer article number
	1m 2m 3m *	mleczna matt frosted	70 % przezroczystości, bardziej elastyczna 70 % transparent, mehr elastisch 70 % transparent, more flexible	1547
		przezroczysta klar transparent	98 % przezroczystości, bardziej elastyczna 98 % transparent, mehr elastisch 98 % transparent, more flexible	1548

* OSŁONKA - K / ABDECKUNG - K / COVER - K: bardzo łatwa w montażu „na klik” / sehr einfach in der Montage (just click !) / very easy to assemble (just click !)

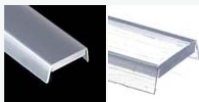
OSŁONKA HS ABDECKUNG HS COVER HS	długość Länge length	osłonka Abdeckung cover	wykończenie powierzchni Oberflächenveredelung surface finishing	numer artykułu Artikelnummer article number
	1m 2m 3m *	mleczna matt frosted	70 % przezroczystości, bardziej sztywna, idealnie płaska 70 % transparent, mehr steif, perfekt flach 70 % transparent, more rigid, perfectly flat	1369
		przezroczysta klar transparent	96 % przezroczystości, bardziej sztywna, idealnie płaska 96 % transparent, mehr steif, perfekt flach 96 % transparent, more rigid, perfectly flat	1370

* OSŁONKA HS / ABDECKUNG HS / COVER HS - nadaje się znakomicie dla opraw, które są poddane drganiom / eignet sich hervorragend für die Fassungen, die Schwingungen ausgesetzt werden / is highly suitable for fixtures that are exposed to vibrations

ZAŚLEPKI ENDKAPPEN END CAPs		numer artykułu Artikelnummer article number
	zaslepka Endkappe end cap	1056
	zaslepka z otworem Endkappe mit Kabelausgangend cap with hole	1057
	zaslepka przewodnikowa Adapter mit Stromversorgung electricity conductive end cap	1407

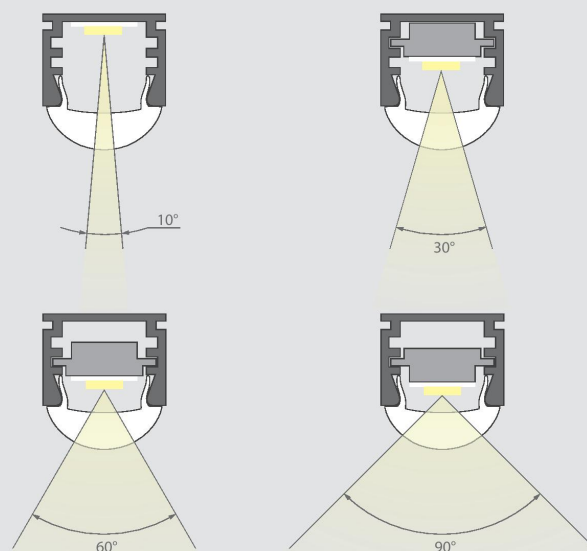

* Die Angaben in unserem Katalog entsprechen dem Stand bei Drucklegung, sind unverbindlich und dienen ausschließlich zu Informationszwecken. Wir behalten uns vor, jederzeit Änderungen an unseren Produkten vorzunehmen.

