

Link to the product: <https://stair-lighting.com/profile-micro-nk-white-p-2807.html>

## Profile MICRO-NK white



Price	<b>7.38 Euro</b>
Availability	<b>Available</b>
Shipping time	<b>4 days</b>
Number	<b>2807</b>
Manufacturer	<b>KLUS</b>

### Product description

#### Important Information

The purchase a piece in the store means the purchase 1 linear meter of the profile or cover

If you want to buy a profile that has a length of 2 meters you have to buy 2 pieces, 3 meters you have to buy 3 pieces, and the multitude of quantity when ordering.

The total length of the aluminum profile or the panel to the profile - is the total quantity of the piece number that was bought in the store.

The choice of the appropriate shipping method will take place at the end of the order process.

[The details of the shipping method and packaging of the aluminum profiles you will find here \(click in the link\)](#)

The product you have selected contains only - aluminum profile - does not include the accessories located in the Accessories tab.

Additional accessories like covers, end caps, electricity conductive end cap, mounting bracket, fasteners, mounting springs, proximity switch, micro switch, mounting system and others are available under "Accessories".

If you are interested in longer lengths than one meter, write to us we will quote the delivery cost to you. Transport companies expect additional charges for long shipments.

For each country is different maximum length of the profile that we can send. It does not depend on us only by courier.

We also do service cutting aluminum profiles to the indicated size - write or call get comprehensive information.

Profile do wbudowania /  
Profile für Einbaumontage

## MICRO-NK

REF. C1587

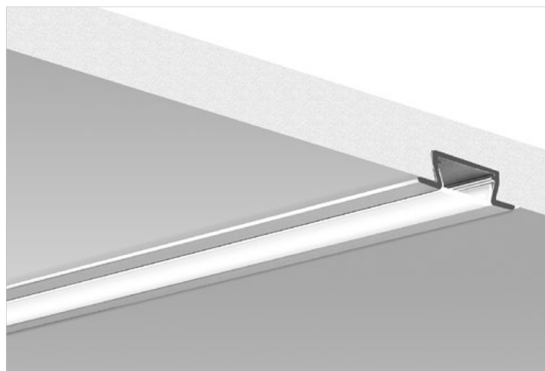

Brak konieczności docinania osłon pod zaślepki.  
Minimalny gabaryt profilu dla pasków LED 10 mm.  
Nowoczesny design.

### PRZEZNACZENIE PRODUKTU:

- do budowy opraw osadzonych w płytach meblowych.

### MONTAŻ:

- za pośrednictwem klejów montażowych.

### DODATKOWE INFORMACJE:

- profil mieści się w płycie o grubości 12 mm.
- wymiar kanału dla zamocowania profilu: 18 mm x 7 mm (głębokość).

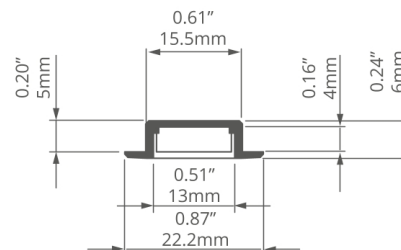

Abdeckungen müssen nicht geschnitten werden, um sie an Endkappen anzupassen.

Mindestprofilgröße für 10 mm LED-Streifen.

Modernes Design.

### ANWENDUNG

- für den Bau von Leuchten eingebaut in Möbelplatten

### MONTAGE

- mit Montageklebern

### ZUSÄTZLICHE INFORMATIONEN

- das Profil passt in eine 12 mm dicke Platte
- Maße des Kanals zur Befestigung des Profils: 18 mm x 7 mm (Tiefe)

### profil / Profil

długość / Länge	szerokość LED / LED-Breite	wykończenie powierzchni / Oberfläche	numer artykułu / Artikelnummer
1 m	10 mm	● Srebrny anodowany / Silber eloxiert	<b>C1587ANODA_1</b>
2 m			<b>C1587ANODA_2</b>
3 m			<b>C1587ANODA_3</b>

### akcesoria / Zubehör

osłony mleczne / opale Abdeckungen	osłony przezroczyste / transparente Abdeckungen	zaślepki szare / graue Endkappen	inne akcesoria / sonstiges Zubehör
KA <b>17035</b>	KA <b>17036</b>	MICRO-K-MW <b>00025</b>	DŁAWNICA 8.8X1.2 / KA- BELVERSCHRAU- BUNG 8.8X1.2 <b>00802</b>
KA-COM <b>17121</b>	KA-COM <b>17122</b>	MICRO-K-OTW-MW <b>00308</b>	
LIGER <b>17037</b>	KA-PRO <b>17065</b>	MICRO-NK-OTW <b>24347</b>	
KA-PRO <b>17064</b>	HS <b>1370</b>	MICRO-NK <b>24346</b>	
LIGER <b>17037OP</b>	osłony czarne / schwarze Abdeckungen	zaślepki białe / weisse Endkappen	
HS <b>1369</b>	LIGER <b>17040</b>	MICRO-K <b>20004</b>	



Recessed extrusions /  
Perfiles empotrados

## MICRO-NK

REF. C1587

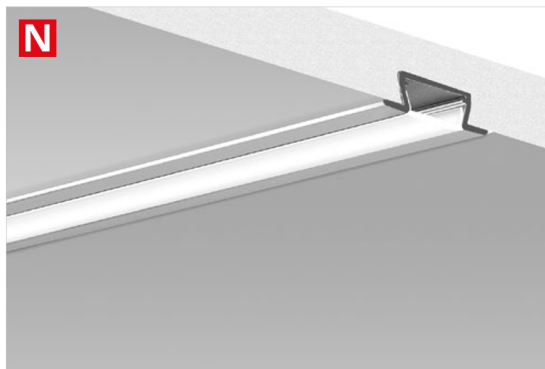

No need to cut covers to fit end caps.  
Minimum extrusion size for a 0.39" / 10 mm LED strip.  
Modern design.

#### APPLICATION

- for making lighting fixtures embedded in furniture boards.

#### ASSEMBLY

- with assembly glue.

#### ADDITIONAL INFORMATION

- the extrusion will fit in 0.47" / 12 mm thick drywall.
- dimensions of the mounting channel for fixing the extrusion: 0.70" / 18 mm x 0.27" / 7 mm (depth).
- the line of light obtainable with a LIGER cover and with a LED strip with a minimum of 36 LED/ft / 120 LED/m.

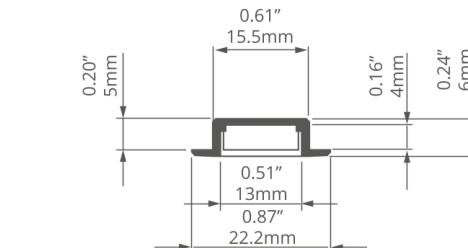

No hay necesidad de cortar los difusores para colocar tapas finales.

Tamaño mínimo del perfil para tiras de LED de 0.39" / 10 mm.

Diseño moderno.

#### APLICACIÓN

- para crear luminarias montadas en paneles de muebles.

#### MONTAJE

- mediante colas de montaje.

#### INFORMACIÓN ADICIONAL

- el perfil cabe en un panel con un grosor de cartón yeso 0.47" / 12 mm de espesor.
- medida del canal para fijar el perfil: 0.70" / 18 mm x 0.27" / 7 mm (profundidad).
- se puede obtener un haz de luz con el difusor LIGER y una tira de LED con una cantidad mínima 36 LED/ft / 120 LED/m.

#### extrusion / perfil

length / longitud	space for LED strip / espacio para tira de LED	surface finish / terminado de superficie	reference number / número de artículo
39.4" / 1 m	0.39" / 10 mm	● Silver anodized / Ánodo de plata	C1587ANODA_1
78.7" / 2 m			C1587ANODA_2
118" / 3 m			C1587ANODA_3

#### accessories / accesorios

frosted covers / difusores escarchados	clear covers / difusores transparentes	grey end caps / tapas finales gris	other accessories / otros accesorios
KA 17035	KA 17036	MICRO-K-MW 00025	8.8x1.2 GLAND / GLÁNDULA 00802
KA-COM 17121	KA-COM 17122	MICRO-K-OTW-MW 00308	
LIGER 17037	KA-PRO 17065	MICRO-NK-OTW 24347	
KA-PRO 17064	HS 1370	MICRO-NK 24346	
LIGER-10M 17037OP			
HS 1369			
	black covers / difusores negro	white end caps / tapas finales blanco	
	LIGER 17040	MICRO-K 20004	

- No need to shorten the covers to fit the end caps
- Minimum profile size for a 10 mm LED strip
- Modern design

#### **Application**

- for creating lighting fixtures recessed in furniture boards

#### **Assembly**

- with mounting adhesive

#### **Additional information**

- the extrusion will fit in 12 mm thick drywall.
- dimensions of the groove for recessing the profile: 18 mm x 7 mm (depth)
- spece for LED strip: 11.2 mm









