

Link to the product: <https://stair-lighting.com/profile-led-inter-with-space-for-power-supply-p-1115.html>



Profile LED INTER with space for power supply

Price	35.71 Euro
Availability	Available
Shipping time	4 days
Number	1115
Manufacturer	KLUS

Product description

Important Information

The purchase a piece in the store means the purchase 1 linear meter of the profile or cover

If you want to buy a profile that has a length of 2 meters you have to buy 2 pieces, 3 meters you have to buy 3 pieces, and the multitude of quantity when ordering.

The total length of the aluminum profile or the panel to the profile - is the total quantity of the piece number that was bought in the store.

The choice of the appropriate shipping method will take place at the end of the order process.

[The details of the shipping method and packaging of the aluminum profiles you will find here \(click in the link\)](#)

Profile for the construction of ceiling fixtures. It has integrated functions: fitting of LEDs and protecting them with a cover (diffuser), surface mounting, as well as an option of installation of power supply and other electronic components, profiles length 100, 200 cm.

The product you have selected contains only - aluminum profile - does not include the accessories located in the Accessories tab.

Additional accessories like covers, end caps, electricity conductive end cap, mounting bracket, fasteners, mounting springs, proximity switch, micro switch, mounting system and others are available under "Accessories".

If you are interested in longer lengths than one meter, write to us we will quote the delivery cost to you. Transport companies expect additional charges for long shipments.

For each country is different maximum length of the profile that we can send. It does not depend on us only by courier.

We also do service cutting aluminum profiles to the indicated size - write or call get comprehensive information.

Profile z komorą na zasilacz /
Profile mit Raum für Netzgeräte

INTER

REF. 18011



Duża przestrzeń na zasilacz, elementy elektroniczne i przyłącze elektryczne.

Prostota konstrukcji.

Łatwy montaż oraz demontaż.

PRZEZNACZENIE PRODUKTU:

- do budowy opraw sufitowych.

MONTAŻ:

- za pomocą listwy montażowej, przytwierdzonej wkrętami odpowiednio dobranymi do rodzaju podłoża,
- za pomocą akcesoriów do podwieszeń.

DODATKOWE INFORMACJE:

- do zastosowań wewnętrznych.

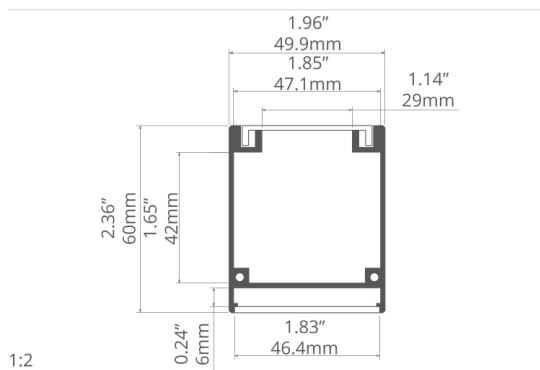

Grosser Raum für das netzteil, den Stromanschluss und elektronische Komponenten.

Einfacher Aufbau.

Leichte Montage und Demontage.

ANWENDUNG

- zur Montage von Deckenbeschläge

MONTAGE

- mit einer Montageleiste, die mit an den Untergrund angepassten Schrauben angeschraubt wird
- mit Abhängezubehör

ZUSÄTZLICHE INFORMATIONEN

- für Innenanwendungen

profil / Profil

długość / Länge	szerokość LED / LED-Breite	wykończenie powierzchni / Oberfläche	numer artykułu / Artikelnummer
1 m	44 mm	● Srebrny anodowany / Silber eloxiert	18011ANODA_1
2 m			18011ANODA_2
3 m			18011ANODA_3

akcesoria / Zubehör

osłony mleczne / opale Abdeckungen	
HSP-47	17051
osłony przezroczyste / transparente Abdeckungen	
HSP-47	17062

zaśleпки szare / graue Endkappen	
INTER	24011
INTER-PLUS	24211
inne akcesoria / sonstiges Zubehör	
DŁAWNICA / KABELVERSCHRAU- BUNG 24x1.6	00820
DŁAWNICA 8.8X1.2 / KABELVERSCHRAU- BUNG 8.8X1.2	00802
WKŁADKA MONTA- ŻOWA 45 / MONTA- GEEINSATZ	70011



Extrusions with space for power supply /
Perfiles con alojamiento para suministro de corriente

INTER

REF. 18011

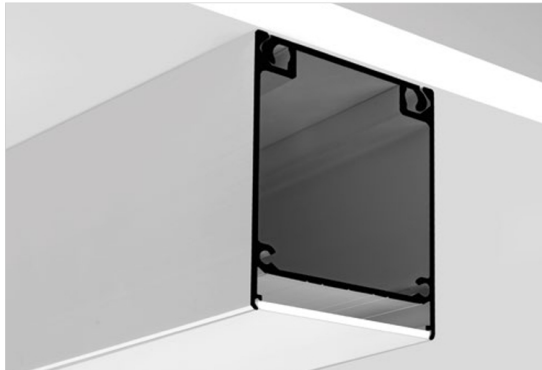

Large chamber for power supply, electronic components and electrical connection.

Simple design.

Easy assembly and disassembly.

APPLICATION

- for construction of ceiling mounted lighting fixtures.

ASSEMBLY

- by means of a mounting strip, fixed with screws appropriately selected for the mounting surface.
- using accessories for suspension.

ADDITIONAL INFORMATION

- for indoor applications.

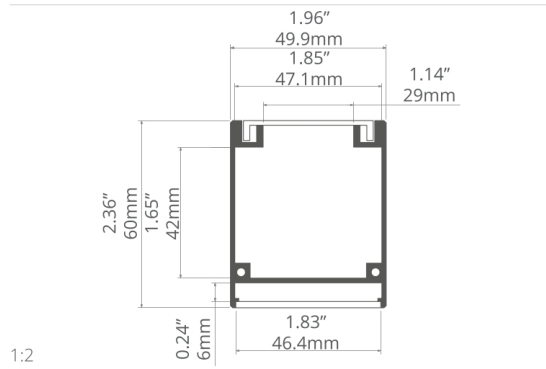

1:2



Cámara grande para el suministro de corriente, componentes electrónicos y conexión eléctrica.

Diseño simple.

Fácil montaje y desmontaje.

APLICACIÓN

- para la construcción de luminarias montadas en techos.

MONTAJE

- por medio de una tira de montaje, fijada con los tornillos seleccionados apropiadamente para la superficie de montaje.
- usando los accesorios para la suspensión.

INFORMACIÓN ADICIONAL

- para los usos de interior.

extrusion / perfil

length / longitud	space for LED strip / espacio para tira de LED	surface finish / terminado de superficie	reference number / número de artículo
39.4" / 1 m			18011ANODA_1
78.7" / 2 m	1.73" / 44 mm	● Silver anodized / Ánodo de plata	18011ANODA_2
118" / 3 m			18011ANODA_3

accessories / accesorios

frosted covers / difusores escarchadas	grey end caps / tapas finales gris
HSP-47 17051	INTER 24011
	INTER-PLUS 24211
clear covers / transparente	other accessories / otros accesorios
HSP-47 17062	8.8x1.2 GLAND / GLÁNDULA 00802
	24x1.6 GLAND / GLÁNDULA 00820
	MOUNTING IN- SERT 45 / INSE- TO DE MONTAJE 70011



INTER LED profile with space for the power adapter is made of high-quality, double anodized aluminum, so it has excellent resistance to damage and it does not undergo the processes of corrosion. The profile has two chambers dedicated light sources, which can be mounted include LED sources. You have to bear in mind that one chamber can be found up to three or four strips / LED strip width are 12 mm and 10 mm each. The profile with remarkable ease, you can also put all the electronic equipment that is necessary to control and power the light, so that it becomes invisible to the eyes, and also more functional.

Profile LED INTER most commonly used in the production of lighting fixtures, which are then placed on a wall or ceiling and shine straight ahead. It includes the integrated functions: LED foundation and securing their diffuser, which acts as a shield. Profile perfectly directs the beam of light straight ahead. It is used to illuminate the pedestrian running both along the walls and ceilings, as well as the corridors are located in different buildings, staircases and many others.

The whole structure consists of two parts: the main part, which is used to mount the LED and hide in the electronic equipment (ie. Some U) and the part that is attached to the substrate (ie. Some Z). Combining the two elements is not the most difficult, because it happens using the method to "click". It should be installed additional security, which are plastic rods. They occur profile, and as a separate item in our store.

LEDs located Profile LED INTER should override fit for him the cover of HSP47, which exists in two versions: milk and transparent. Both versions are made of polycarbonate and certified, which ensures excellent resistance to all possible weather conditions, so they can serve us for a long time. Each of the shields is also UV-resistant and flame retardant.

Profile is recommended to purchase for him a dedicated caps, which are made of polypropylene and the elements, which are designed to allow the connection of mechanical and electrical all other elements belonging to the luminaire. All details can be found on our website under "Accessories".

We invite you to familiarize yourself with our offer. &

0.9 / Profile z komorą na zasilacz / Extrusions with space to conceal power supplies / Profile mit raum für Netzgeräte

INTER-KPL

PL / Komplet profili do **budowy** wydajnych opraw sufitowych i podwieszanych.

EN / A set of extrusions for **construction** of efficient ceiling and suspended lighting fixtures.

DE / Ein Satz der Profile **zum Bau der** effizienten Leuchten für die Decken und untergehängte Decken.

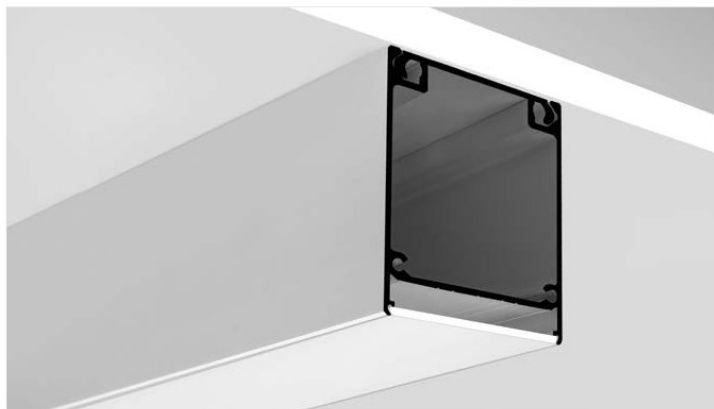
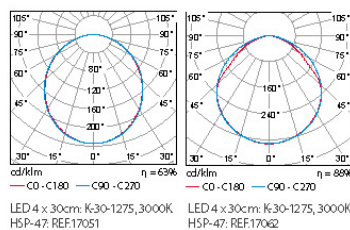
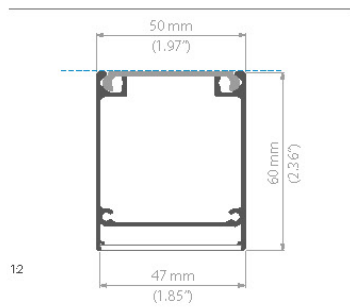

INTER-KPL

dlugość length Länge	szerokość paska LED LED strip width Breite LED Band	wykończenie powierzchni surface finish Oberfläche	numer artykułu article number Artikelnummer
1m (standard) 2m (standard) 3m (standard) 3 - 6m *	4 x LED strip max. 10,8 mm	● anodowany / anodized / eloxiert	18011ANODA

** Na specjalne zamówienie / Special order / Sonderbestellung.

akcesoria / accessories / zubehör

OSŁONKI / COVERS / ABDECKUNGEN

	HSP-47	łatwy montaż, dobre rozpraszanie światła / easy to assemble, very good light dispersion / einfach zu montieren sehr gute Lichtstreuung	1m, 2m, 3m (standard)	PC	mleczna / frosted / opak	17051
					przezroczysta / transparent	17062

ZASŁEPKI / END CAP / ENDKAPPEN

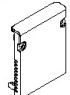
	INTER	zasłepka podstawowa / basic end cap / Endkappe	PP	● jasno szara / light gray / hellgrau	24011
	INTER-PLUS-KPL	zasłepka podstawowa / basic end cap / Endkappe		● jasno szara / light gray / hellgrau	24211

AKCESORIA MONTAŻOWE / MOUNTING ACCESSORIES / MOUNTING ACCESSORIES

	PUSZ-PRET-LEB	zawieszka / fastener / Abhängung			42253
	PUSZ-LIN-LEB	zawieszka / fastener / Abhängung			42259
		Płyta montażowa pod zasilacz / Power supply mounting plate / Montageplatte für Netzgerät			70011
		Pręt z tworzywa ø 2,4mm. Do blokady płyty montażowej pod zasilacz / Plastic rod ø 2.4 mm. For the locking of the power supply mounting plate / Kunststoffstange von ø 2,4 mm. Zur Blockade der Montageplatte für Netzgerät			42221

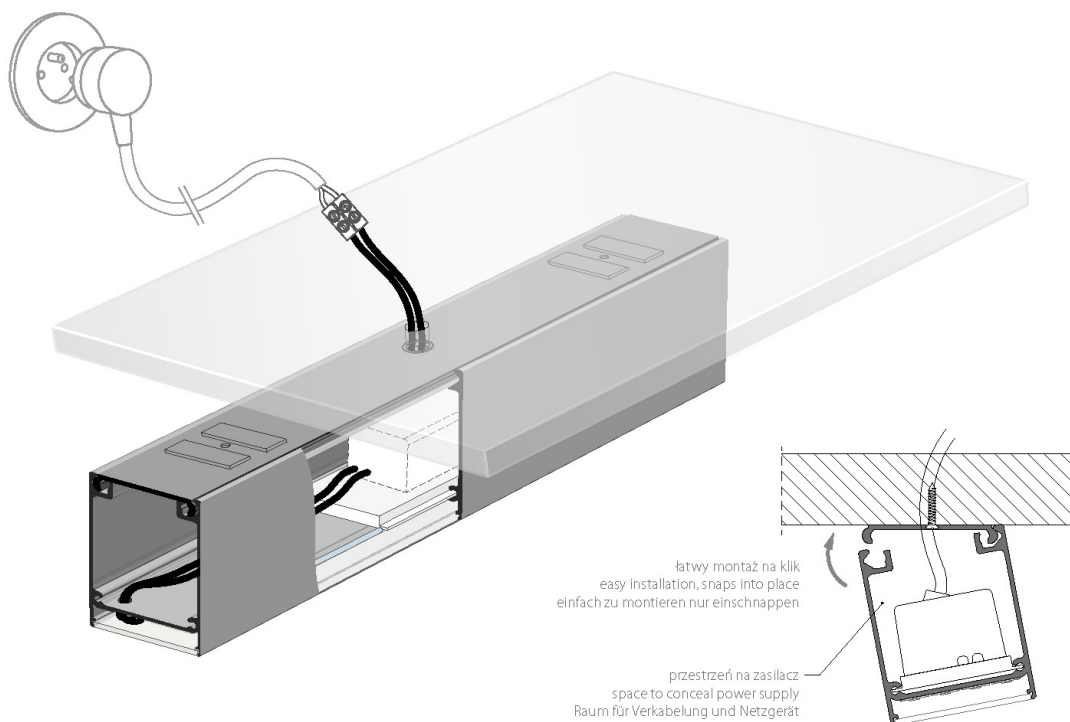



INTER KPL.

Przestrzeń na zasilacz Space to conceal power supply
Raum für Verkabelung und Netzgerät

82



INTERSET

Lampa / Lamp LED Fixture / LED Leuchte

142

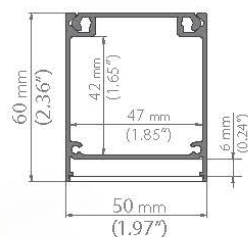

INTERSET	długość length Länge	szerokość paska LED LED strip width LED Strip Breite	wykończenie powierzchni surface finish Oberfläche	osłona cover Abdeckung	numer artykułu article number Artikelnummer
	330 mm	4 x LED strip max. 10 mm	profil: anodowany profile: anodized Profil: eloxiert	mleczna frosted opak	43111
	1000 mm				43112
	2000 mm				43113
	330 mm	3 x LED strip max. 12 mm		przezroczysta transparent	43138
	1000 mm				43139
	2000 mm				43140

- PL **Komplet do budowy opraw sufitowych.** Nie zawiera źródeł światła LED oraz zasilacza!
Komora z przestrzenią na zasilacz wyposażona jest w płytkę montażową służącą do bezpiecznego mocowania zasilacza, zrywki i innych elementów.
Zestaw zawiera: profil INTER, profil BOX-Z, 2 zaślepki, osłonka, płytka montażowa, pręty z tworzywa, klucze imbusowe, do dyski.
- EN **Set for construction of ceiling fixtures.** Does not include LED lights and power supply.
Compartment with space for the power supply is equipped with a mounting plate for the secure mounting of the power supply, electric terminal and other items.
Set contains: INTER profile, BOX-Z profile, 2 end caps, cover, mounting plate, plastic rods, allen keys, pressure screws.
- DE **Set zum Bau einer Deckenleuchte.** Leergehäuse ohne Netzgerät!
Der Platz für die Stromversorgung und die Anschlußklemmen ist vorhanden.
Set Inhalt: Profil INTER, Profil BOX-Z, 2 Endkappen, Abdeckung, Montageplatte für Spannungsversorgung, Plastik Verbindungsstifte, Inbusschlüssel, Verschraubung.

Oprawy LED LED lighting fixtures



łatwy montaż na klik

easy installation
snaps into place

Einfache
Einschnappmontage

