

Link to the product: <https://stair-lighting.com/profile-led-inter-with-space-for-power-supply-any-ral-color-p-2352.html>



Profile LED INTER with space for power supply - any RAL color

Price	52.50 Euro
Availability	Available
Shipping time	14 days
Number	2352
Manufacturer	KLUS

Product description

Important Information

The purchase a piece in the store means the purchase 1 linear meter of the profile or cover

If you want to buy a profile that has a length of 2 meters you have to buy 2 pieces, 3 meters you have to buy 3 pieces, and the multitude of quantity when ordering.

The total length of the aluminum profile or the panel to the profile - is the total quantity of the piece number that was bought in the store.

The choice of the appropriate shipping method will take place at the end of the order process.

[The details of the shipping method and packaging of the aluminum profiles you will find here \(click in the link\)](#)

Profile for the construction of ceiling fixtures. It has integrated functions: fitting of LEDs and protecting them with a cover (diffuser), surface mounting, as well as an option of installation of power supply and other electronic components, profiles length 100, 200 cm.

The product you have selected contains only - aluminum profile - does not include the accessories located in the Accessories tab.

Additional accessories like covers, end caps, electricity conductive end cap, mounting bracket, fasteners, mounting springs, proximity switch, micro switch, mounting system and others are available under "Accessories".

If you are interested in longer lengths than one meter, write to us we will quote the delivery cost to you. Transport companies expect additional charges for long shipments.

For each country is different maximum length of the profile that we can send. It does not depend on us only by courier.

We also do service cutting aluminum profiles to the indicated size - write or call get comprehensive information.

INTER LED profile with space for the power adapter is made of high-quality, double anodized aluminum, so it has excellent resistance to damage and it does not undergo the processes of corrosion. The profile has two chambers dedicated light sources, which can be mounted include LED sources. You have to bear in mind that one chamber can be found up to three or four strips / LED strip width are 12 mm and 10 mm each. The profile with remarkable ease, you can also put all the electronic equipment that is necessary to control and power the light, so that it becomes invisible to the eyes, and also more functional.

Profile LED INTER most commonly used in the production of lighting fixtures, which are then placed on a wall or ceiling and

shine straight ahead. It includes the integrated functions: LED foundation and securing their diffuser, which acts as a shield. Profile perfectly directs the beam of light straight ahead. It is used to illuminate the pedestrian running both along the walls and ceilings, as well as the corridors are located in different buildings, staircases and many others.

The whole structure consists of two parts: the main part, which is used to mount the LED and hide in the electronic equipment (ie. Some U) and the part that is attached to the substrate (ie. Some Z). Combining the two elements is not the most difficult, because it happens using the method to "click". It should be installed additional security, which are plastic rods. They occur profile, and as a separate item in our store.

LEDs located Profile LED INTER should override fit for him the cover of HSP47, which exists in two versions: milk and transparent. Both versions are made of polycarbonate and certified, which ensures excellent resistance to all possible weather conditions, so they can serve us for a long time. Each of the shields is also UV-resistant and flame retardant.

Profile is recommended to purchase for him a dedicated caps, which are made of polypropylene and the elements, which are designed to allow the connection of mechanical and electrical all other elements belonging to the luminaire. All details can be found on our website under "Accessories".

We invite you to familiarize yourself with our offer.

RAL 1000	RAL 1001	RAL 1002	RAL 1003	RAL 1004	RAL 1005	RAL 1006	RAL 1007
RAL 1011	RAL 1012	RAL 1013	RAL 1014	RAL 1015	RAL 1016	RAL 1017	RAL 1018
RAL 1019	RAL 1020	RAL 1021	RAL 1023	RAL 1024	RAL 1027	RAL 1028	RAL 1032
RAL 1033	RAL 1034	RAL 2000	RAL 2001	RAL 2002	RAL 2003	RAL 2004	RAL 2008
RAL 2009	RAL 2010	RAL 2011	RAL 2012	RAL 3000	RAL 3001	RAL 3002	RAL 3003
RAL 3004	RAL 3005	RAL 3007	RAL 3009	RAL 3011	RAL 3012	RAL 3013	RAL 3014
RAL 3015	RAL 3016	RAL 3017	RAL 3018	RAL 3020	RAL 3022	RAL 3027	RAL 3031
RAL 4001	RAL 4002	RAL 4003	RAL 4004	RAL 4005	RAL 4006	RAL 4007	RAL 4008
RAL 4009	RAL 5000	RAL 5001	RAL 5002	RAL 5003	RAL 5004	RAL 5005	RAL 5007
RAL 5008	RAL 5009	RAL 5010	RAL 5011	RAL 5012	RAL 5013	RAL 5014	RAL 5015
RAL 5017	RAL 5018	RAL 5019	RAL 5020	RAL 5021	RAL 5022	RAL 5023	RAL 5024
RAL 6000	RAL 6001	RAL 6002	RAL 6003	RAL 6004	RAL 6005	RAL 6006	RAL 6007
RAL 6008	RAL 6009	RAL 6010	RAL 6011	RAL 6012	RAL 6013	RAL 6014	RAL 6015
RAL 6016	RAL 6017	RAL 6018	RAL 6019	RAL 6020	RAL 6021	RAL 6022	RAL 6024
RAL 6025	RAL 6026	RAL 6027	RAL 6028	RAL 6029	RAL 6032	RAL 6033	RAL 6034
RAL 7000	RAL 7001	RAL 7001	RAL 7002	RAL 7003	RAL 7004	RAL 7005	RAL 7006
RAL 7008	RAL 7009	RAL 7010	RAL 7011	RAL 7012	RAL 7013	RAL 7015	RAL 7016
RAL 7021	RAL 7022	RAL 7023	RAL 7024	RAL 7026	RAL 7030	RAL 7031	RAL 7032
RAL 7033	RAL 7034	RAL 7035	RAL 7036	RAL 7037	RAL 7038	RAL 7039	RAL 7040
RAL 7042	RAL 7043	RAL 7044	RAL 8000	RAL 8001	RAL 8002	RAL 8003	RAL 8004
RAL 8007	RAL 8008	RAL 8011	RAL 8012	RAL 8014	RAL 8015	RAL 8016	RAL 8017
RAL 8019	RAL 8022	RAL 8023	RAL 8024	RAL 8025	RAL 8028	RAL 9001	RAL 9002
RAL 9003	RAL 9004	RAL 9005	RAL 9010	RAL 9011	RAL 9016	RAL 9017	RAL 9018

0.9 / Profile z komorą na zasilacz / Extrusions with space to conceal power supplies / Profile mit raum für Netzgeräte

INTER-KPL

PL / Komplet profili do **budowy** wydajnych opraw sufitowych i podwieszanych.

EN / A set of extrusions for **construction** of efficient ceiling and suspended lighting fixtures.

DE / Ein Satz der Profile **zum Bau** der effizienten Leuchten für die Decken und untergehängte Decken.

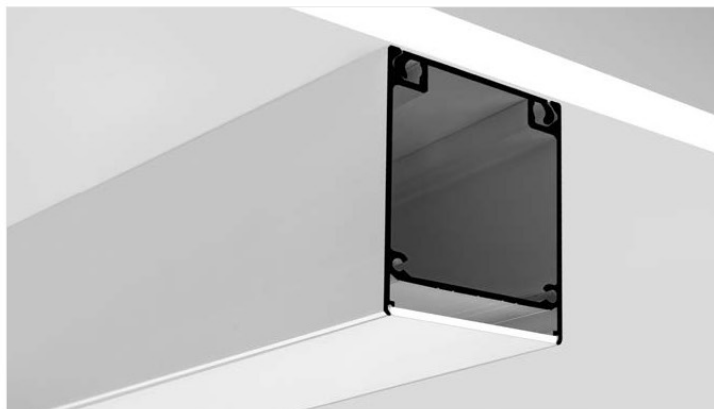
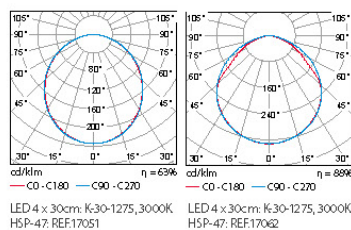
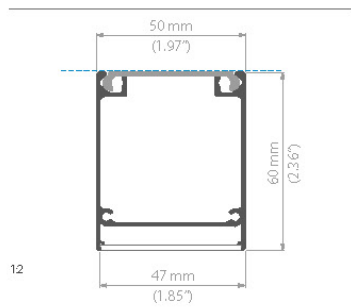

INTER-KPL

dlugość length Länge	szerokość paska LED LED strip width Breite LED Band	wykończenie powierzchni surface finish Oberfläche	numer artykułu article number Artikelnummer
1m (standard) 2m (standard) 3m (standard) 3 - 6m *	4 x LED strip max. 10,8 mm	● anodowany / anodized / eloxiert	18011ANODA

** Na specjalne zamówienie / Special order / Sonderbestellung.

akcesoria / accessories / zubehör

OSŁONKI / COVERS / ABDECKUNGEN

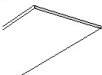
	HSP-47	łatwy montaż, dobre rozpraszanie światła / easy to assemble, very good light dispersion / einfach zu montieren sehr gute Lichtstreuung	1m, 2m, 3m (standard)	PC	mleczna / frosted / opak	17051
					przezroczysta / transparent	17062

ZASŁEPKI / END CAP / ENDKAPPEN

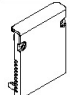
	INTER	zasłepka podstawowa / basic end cap / Endkappe	PP	● jasno szara / light gray / hellgrau	24011
	INTER-PLUS-KPL	zasłepka podstawowa / basic end cap / Endkappe		● jasno szara / light gray / hellgrau	24211

AKCESORIA MONTAŻOWE / MOUNTING ACCESSORIES / MOUNTING ACCESSORIES

	PUSZ-PRET-LEB	zawieszka / fastener / Abhängung			42253
	PUSZ-LIN-LEB	zawieszka / fastener / Abhängung			42259
		Płyta montażowa pod zasilacz / Power supply mounting plate / Montageplatte für Netzgerät			70011
		Pręt z tworzywa ø 2,4mm. Do blokady płyty montażowej pod zasilacz / Plastic rod ø 2.4 mm. For the locking of the power supply mounting plate / Kunststoffstange von ø 2,4 mm. Zur Blockade der Montageplatte für Netzgerät			42221

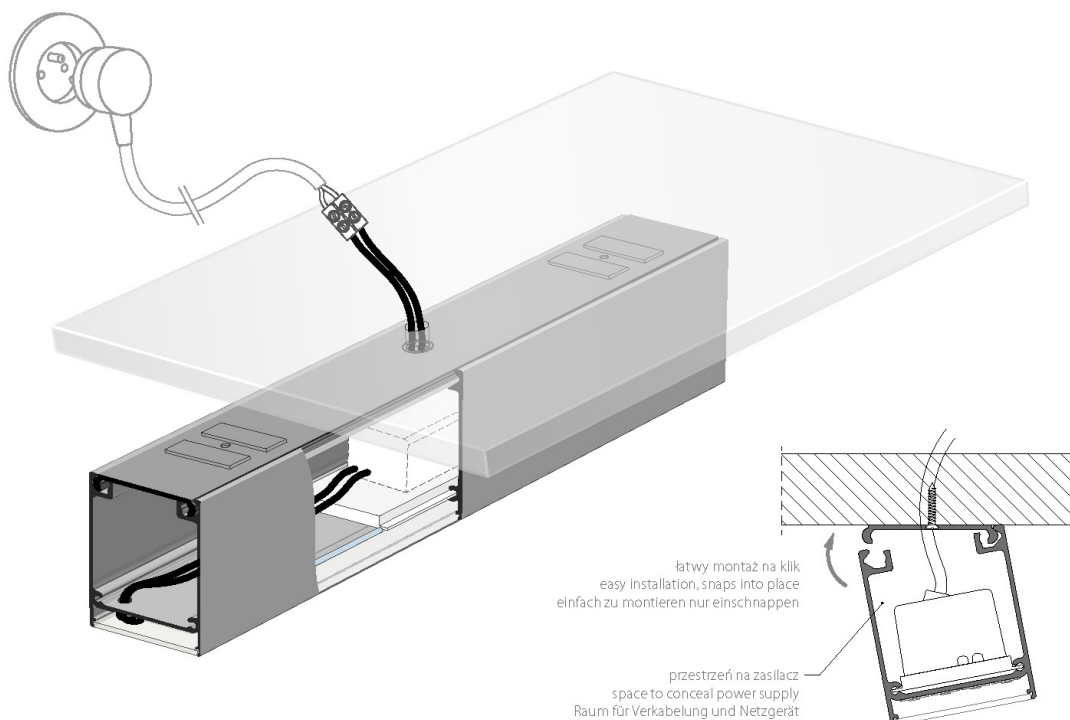



INTERSET

Lampa / Lamp LED Fixture / LED Leuchte

142

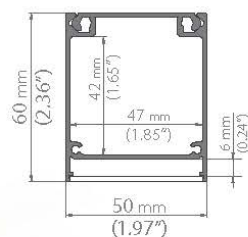

INTERSET	długość length Länge	szerokość paska LED LED strip width LED Strip Breite	wykończenie powierzchni surface finish Oberfläche	osłodka cover Abdeckung	numer artykułu article number Artikelnummer
	330 mm	4 x LED strip max. 10 mm	profil: anodowany profile: anodized Profil: eloxiert	mleczna frosted opak	43111
	1000 mm				43112
	2000 mm				43113
	330 mm	3 x LED strip max. 12 mm		przezroczysta transparent	43138
	1000 mm				43139
	2000 mm				43140

- PL **Komplet do budowy opraw sufitowych.** Nie zawiera źródeł światła LED oraz zasilacza!
Komora z przestrzenią na zasilacz wyposażona jest w płytkę montażową służącą do bezpiecznego mocowania zasilacza, zrywki i innych elementów.
Zestaw zawiera: profil INTER, profil BOX-Z, 2 zaślepki, osłonka, płytka montażowa, pręty z tworzywa, klucze imbusowe, do dyski.
- EN **Set for construction of ceiling fixtures.** Does not include LED lights and power supply.
Compartment with space for the power supply is equipped with a mounting plate for the secure mounting of the power supply, electric terminal and other items.
Set contains: INTER profile, BOX-Z profile, 2 end caps, cover, mounting plate, plastic rods, allen keys, pressure screws.
- DE **Set zum Bau einer Deckenleuchte.** Leergehäuse ohne Netzgerät!
Der Platz für die Stromversorgung und die Anschlußklemmen ist vorhanden.
Set Inhalt: Profil INTER, Profil BOX-Z, 2 Endkappen, Abdeckung, Montageplatte für Spannungsversorgung, Plastik Verbindungsstifte, Inbusschlüssel, Verschraubung.

Oprawy LED LED lighting fixtures



łatwy montaż na klik

easy installation
snaps into place

Einfache
Einschnappmontage

