

Link to the product: <https://stair-lighting.com/profiel-led-kozma-p-2079.html>

Profiel LED KOZMA

Price	12.54 Euro
Availability	Available
Shipping time	5 days
Number	2079
Manufacturer	KLUS

Product description

Important Information

The purchase a piece in the store means the purchase 1 linear meter of the profile or cover

If you want to buy a profile that has a length of 2 meters you have to buy 2 pieces, 3 meters you have to buy 3 pieces, and the multitude of quantity when ordering.

The total length of the aluminum profile or the panel to the profile - is the total quantity of the piece number that was bought in the store.

The choice of the appropriate shipping method will take place at the end of the order process.

[The details of the shipping method and packaging of the aluminum profiles you will find here \(click in the link\)](#)

Price for 1 meter length profile - no cover and end caps.

The product you have selected contains only - aluminum profile - does not include the accessories located in the Accessories tab.

Additional accessories like covers, end caps, electricity conductive end cap, mounting bracket, fasteners, mounting springs, proximity switch, micro switch, mounting system and others are available under "Accessories".

If you are interested in longer lengths than one meter, write to us we will quote the delivery cost to you. Transport companies expect additional charges for long shipments.

For each country is different maximum length of the profile that we can send. It does not depend on us only by courier.

We also do service cutting aluminum profiles to the indicated size - write or call get comprehensive information.

Profile architektoniczne /
Architekturprofile

KOZMA

REF. 18040

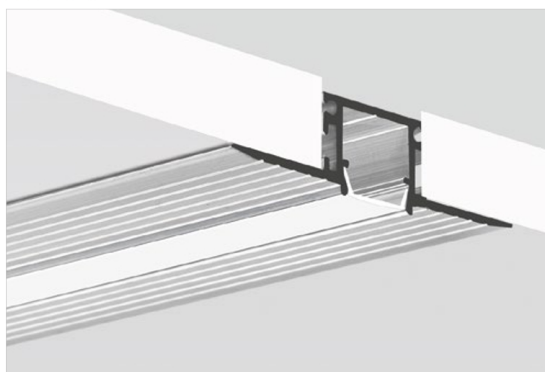

Wąska linia światła.

Profil zlicowany z płaszczyzną sufitu lub ściany.

Niewidoczne elementy aluminium.

PRZEZNACZENIE PRODUKTU:

- do budowy oprawy uzyskującej efekt linii światła zlicowanej z płaszczyzną sufitu, bez widocznych elementów aluminiowych.

MONTAŻ:

- do montażu w płycie kartonowo - gipsowej za pomocą klejów montażowych, następnie siatkowany i wykańczany gipsem.

DODATKOWE INFORMACJE:

- WKŁADKA OCHRONNA TECH-KA zapewnia zachowanie szerokości gniazda profilu dla wpinanej osłony (jej stosowanie jest konieczne podczas czynności montażowych i wykończeniowych).

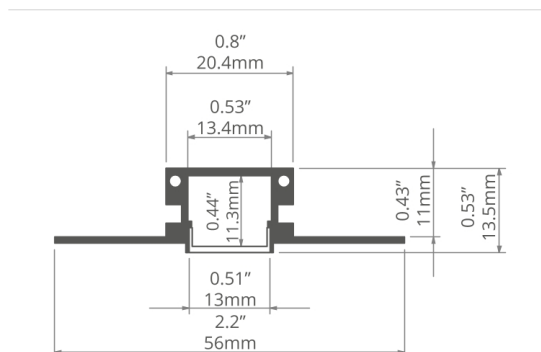

Schmale Lichtlinie.

Profil bündig mit der Wand bzw. Decke.

Aluteile nicht zu sehen.

ANWENDUNG

- zur Montage einer Leuchte, die Lichtlinie erzeugt, bündig mit der Deckenfläche, mit unsichtbaren Aluteilen

MONTAGE

- zur Montage in der GKP mit Montageklebern, dann mit Montagenetz und Gips bedeckt

ZUSÄTZLICHE INFORMATIONEN

- Die Schutzeinlage TECH-KA stellt sicher, dass der Profilschlitz für die Einrastabdeckung breit genug bleibt (ihre Verwendung ist bei der Montage und Fertigstellung NOTWENDIG)

profil / Profil

długość / Länge	szerokość LED / LED-Breite	wykończenie powierzchni / Oberfläche	numer artykułu / Artikelnummer
1 m	13 mm	Nieanodowany (surowe aluminium) / Nicht eloxiert (Aluminum Natur)	18040NA_1
2 m			18040NA_2
3 m			18040NA_3

akcesoria / Zubehör

osłony mleczne / opale Abdeckungen	osłony czarne / schwarze Abdeckungen	łączniki / Verbindungsstücke	inne akcesoria / sonstiges Zubehör
KA 17035	LIGER 17040	ZM-NA-180 42724	TECH-KA WKŁAD- KA OCHRONNA / SCHUTZ EINSATZ 17123
KA-COM 17121	zaślepki szare / graue Endkappen	ZM-NA-90 42723	DŁAWNICA 8.8X1.2 / KABELVERSCHRAU- BUNG 8.8X1.2 00802
HS 1369	KOZMA 24217	ZM-NA-120 42729	
LIGER 17037		ZM-NA-135 42725	
KA-PRO 17064		ZM-NA-PION-90 42726	
		ZM-NA-PION-135 42727	
osłony przezroczyste / transparente Abdeckungen			
KA 17036			
KA-COM 17122			
HS 1370			
KA-PRO 17065			

Architectural extrusions /
Perfiles arquitectónicos

KOZMA

REF. 18040

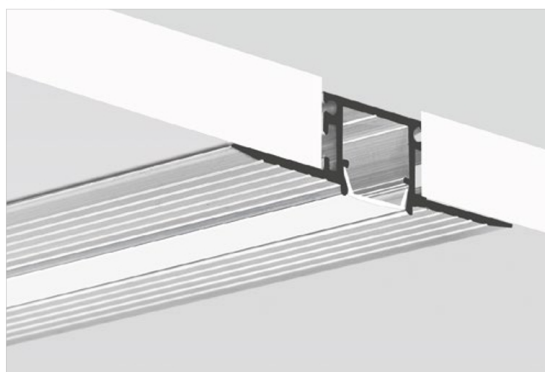

Narrow line of light.
Extrusion flush with the ceiling or wall surface.
Invisible aluminum components.

APPLICATION

- for a fixture with the line-of-light effect, flush with the ceiling surface, without visible aluminum elements.

ASSEMBLY

- for mounting in a cardboard-gypsum board using fixing glues, then meshed and finished with plaster.

ADDITIONAL INFORMATION

- can be with an additional protective insert, which protects essential elements against soiling during mounting.

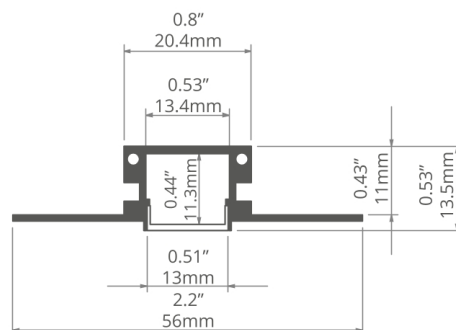

Estrecha línea de luz.
Perfil al ras con el techo o la superficie de la pared.
Componentes de aluminio invisible.

APLICACIÓN

- para una luminaria con efecto de línea de luz, al ras con la superficie del techo, sin elementos de aluminio visibles.

MONTAJE

- para el montaje en una cartulina-tablero de yeso usando pegamentos de la fijación, entonces engranado y acabado con el yeso.

INFORMACIÓN ADICIONAL

- equipado con una cubierta técnica adicional, que protege los elementos esenciales contra la suciedad durante el montaje.

extrusion / perfil

length / longitud	space for LED strip / espacio para tira de LED	surface finish / terminado de superficie	reference number / número de artículo
39.4" / 1 m	0.53" / 13 mm	Non anodized (raw) / Aluminio crudo (no anodizado)	18040NA_1
78.7" / 2 m			18040NA_2
118" / 3 m			18040NA_3

accessories / accesorios

frosted covers / difusores escarchadas	black covers / difusores negro	connectors / conectores	other accessories / otros accesorios
KA 17035	LIGER 17040	ZM-NA-180 42724	8.8x1.2 GLAND / GLÁNDULA 00802
KA-COM 17121	grey end caps / tapas finales gris	ZM-NA-90 42723	TECH-KA PROTECTIVE INSERT / INSERTO PROTECTOR 17123
HS 1369	KOZMA 24217	ZM-NA-120 42729	
LIGER 17037		ZM-NA-135 42725	
KA-PRO 17064		ZM-NA-PION-90 42726	
		ZM-NA-PION-135 42727	
clear covers / difusores transparentes			
KA 17036			
KA-COM 17122			
HS 1370			
KA-PRO 17065			

The Kozma-KPL profile is a low-profile profile for mounting in the inlets. Designed to be covered with plaster, and its purpose is to create a line of light.

Description:

Kozma-KPL is used in interior architecture. The product allows creating unique compositions consisting of thin lines of light on the surfaces of ceilings and walls. Due to the covering of aluminum elements, only the stylish cover line remains on the surface, which greatly affects the visual effects in the room.

Mounting method:

Appropriate installation of the profile consists in embedding it in the groove with the use of assembly glue. A plasterboard should be applied to the wings and the whole should be repaired and then sanded. We must do this so that the base edge of the product remains intact. Finally, apply a coat of paint and remove the work cover. Paste the LED and put on a clean cover.





