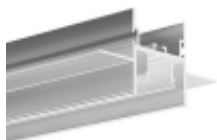

Link to the product: <https://stair-lighting.com/profiel-led-foled-p-2082.html>

Profiel LED FOLED

Price	12.79 Euro
Availability	Available
Shipping time	5 days
Number	2082
Manufacturer	KLUS

Product description

Important Information

The purchase a piece in the store means the purchase 1 linear meter of the profile or cover

If you want to buy a profile that has a length of 2 meters you have to buy 2 pieces, 3 meters you have to buy 3 pieces, and the multitude of quantity when ordering.

The total length of the aluminum profile or the panel to the profile - is the total quantity of the piece number that was bought in the store.

The choice of the appropriate shipping method will take place at the end of the order process.

[The details of the shipping method and packaging of the aluminum profiles you will find here \(click in the link\)](#)

Price for 1 meter length profile - no cover and end caps.

The product you have selected contains only - aluminum profile - does not include the accessories located in the Accessories tab.

Additional accessories like covers, end caps, electricity conductive end cap, mounting bracket, fasteners, mounting springs, proximity switch, micro switch, mounting system and others are available under "Accessories".

If you are interested in longer lengths than one meter, write to us we will quote the delivery cost to you. Transport companies expect additional charges for long shipments.

For each country is different maximum length of the profile that we can send. It does not depend on us only by courier.

We also do service cutting aluminum profiles to the indicated size - write or call get comprehensive information.

Profile do budowy sufitów w technologii napinanej folii /
Profile für Folienspanndecken

FOLED

REF. B8332V1

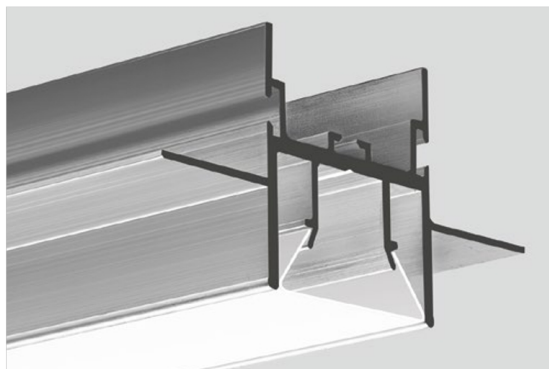

Łączy kilka funkcji: oprawy oświetleniowej, stelażu dla sufitu napinanego, stelażu dla sufitu podwieszanego z karton-gipsu.

Jest kompatybilny ze standardowymi mocowaniami sufitów podwieszanych.

System FOLED otwiera nowe możliwości aranżacji wnętrz.

PRZEZNACZENIE PRODUKTU:

- do budowy sufitów w technologii „napinanej folii” ze zintegrowanym oświetleniem LED. Profil posiada kanał przystosowany do mocowania standardowych harpunów stosowanych w powierzchniach napinanych,
- do budowy sufitów podwieszanych z karton gipsu.

MONTAŻ:

- za pośrednictwem profilu FOLHAK i dostępnych na rynku zawieszek sufitów podwieszanych.

DODATKOWE INFORMACJE:

- przewidziany jest do zastosowań wewnętrznych,
- profile można łączyć pod każdym kątem większym niż 60 stopni,
- oprawa jest zlicowana z płaszczyzną folii,
- łatwe łączenie za pomocą „ŁĄCZNIKÓW ZM”,
- współpracuje z całą rodziną profili FOLED.

profil / Profil

długość / Länge	szerokość LED / LED-Breite	wykończenie powierzchni / Oberfläche	numer artykułu / Artikelnummer
1 m	13 mm	Nieanodowany (surowe aluminium) /	B8332V1NA_1
2 m		Nicht eloxiert	B8332V1NA_2
3 m		(Aluminum Natur)	B8332V1NA_3

akcesoria / Zubehör

osłony mleczne / opale Abdeckungen	zaślepki białe / weisse Endkappen	łączniki / Verbindungsstücke	profil / Profil
FOLED 17077V1	FOLED-W 24277	ZM-NA-180 42724	FOLHAK B8338
osłony czarne / schwarze Abdeckungen	zaślepki czarne / schwarze Endkappen	ZM-NA-90 42723	FOLED-BOK B8334V1
FOLED 17045	FOLED-W 24285	ZM-NA-120 42729	FOLED-SUF B8333V1
		ZM-NA-135 42725	
		ZM-NA-PION-90 42726	inne akcesoria / sonstiges Zubehör
		ZM-NA-PION-135 42727	DŁAWNICA 8.8X1.2 / KABELVERSCHRAU- BUNG 8.8X1.2 00802

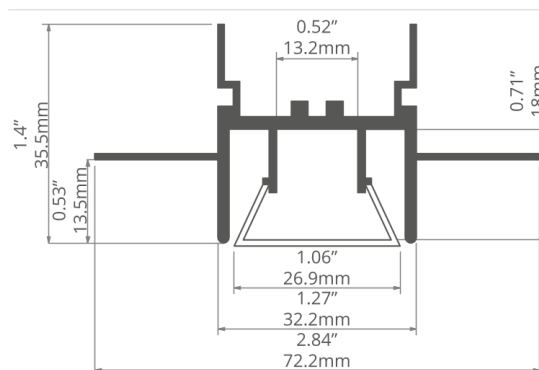

Verbindet mehrere Funktionen: Leuchte, Gestell für die Spanndecke, Gestell für die Hängedecke aus Gipskarton.

Kompatibel mit den standardmässigen Befestigungen der Hängedecken.

System FOLED bietet neue Möglichkeiten der Raumgestaltung.

ANWENDUNG

- zur Montage von Folienspanndecken mit integrierter LED-Beleuchtung. Das Profil besitzt eine Rinne, wo Standardharpune, die bei Spannflächen eingesetzt werden, befestigt werden können
- zur Montage von Hängedecken aus Gipskarton

MONTAGE

- mit Profil FOLHAK und im Handel erhältlichen Befestigungen von Hängedecken

ZUSÄTZLICHE INFORMATIONEN

- für Innenanwendungen
- die Profile können in einem beliebigen Winkel von mehr als 60 Grad verbunden werden
- Leuchte bündig mit der Foliensoberfläche
- leichtes Verbinden mit „ŁĄCZNIKÓW ZM”
- kompatibel mit allen Profilen FOLED

Extrusions for building ceilings employing the stretch-film technology /
Perfiles para construir la tecnología de techos tensados

FOLED

REF. B8332V1

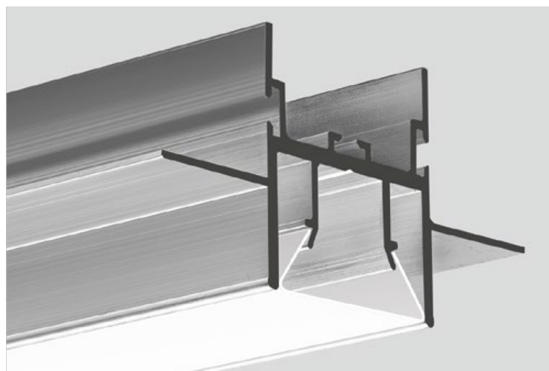

Combines several functions: lighting fixture, frame for a stretched ceiling, frame for a suspended ceiling made of plasterboard, etc.

Compatible with standard fasteners for suspended ceilings.

The foled system opens new possibilities of interior design.

APPLICATION

- for building ceilings employing the stretch-film technology with integrated LED lighting.
- for building suspended ceilings with plasterboard.
- the extrusion has a channel adapted to attach standard harpoons used in stretched surfaces.

ASSEMBLY

- with the FOLHAK connectors and suspended ceiling hangers available on the market.

ADDITIONAL INFORMATION

- intended for indoor use.
- extrusions can be connected with each other at an angle over 60°.
- fixture is flush with the plane of the film.
- easy connection using "ZM CONNECTORS".
- compatible with the whole FOLED extrusion family.

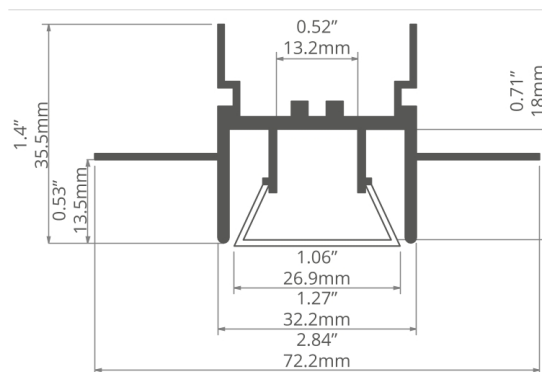

Combina varias funciones: luminarios, marco para un techo tensado, marco para techos falso de panel de yeso, etc.

Compatible con fijaciones estándar para techos falsos.

El sistema FOLED abre nuevas posibilidades de diseño de interiores.

APLICACIÓN

- para la construcción de techos que emplean la tecnología techo tensado iluminación LED integrada.
- para la construcción de techos falso de panel de yeso.
- el perfil dispone de un canal adaptado para la fijación de arpones estándar utilizados en superficies estiradas.

MONTAJE

- con los conectores "FOLHAK" y los colgadores suspendidos del techo disponibles en el mercado.

INFORMACIÓN ADICIONAL

- diseñado para uso en interiores.
- los perfiles se pueden conectar entre sí en un ángulo de más de 60°.
- luminaria está nivelado con el plano de el recubrimiento.
- conexión fácil usando "conectores ZM".
- compatible con toda la familia de perfiles FOLED.

extrusion / perfil

length / longitud	space for LED strip / espacio para tira de LED	surface finish / terminado de superficie	reference number / número de artículo
39.4" / 1 m	0.5" / 13 mm	 Non anodized (raw) / Aluminio crudo (no anodizado)	B8332V1NA_1
78.7" / 2 m			B8332V1NA_2
118" / 3 m			B8332V1NA_3

accessories / accesorios

frosted covers / difusores escarchadas	white end caps / tapas finales blanco	connectors / conectores	extrusions / perfiles
FOLED 17077V1	FOLED-W 24277	ZM-NA-180 42724	FOLHAK B8338
black covers / difusores negro	black end caps / tapas finales negro	ZM-NA-90 42723	FOLED-BOK B8334V1
FOLED 17045	FOLED-W 24285	ZM-NA-120 42729	FOLED-SUF B8333V1
		ZM-NA-135 42725	other accessories / otros accesorios
		ZM-NA-PION-90 42726	8.8x1.2 GLAND / GLÁNDULA 00802
		ZM-NA-PION-135 42727	

The FOLED v-1 profile combines the function of a light fixture, a frame for a stretch ceiling and a frame for a suspended ceiling made of materials such as cardboard or gypsum.

The product works with standard fixing of suspended ceilings and provides a lot of possibilities in modern interior design.

FOLED v-1 is used in the construction of ceilings in "stretch film" technology, including integrated LED lighting, as well as in the construction of suspended ceilings.

The product has a channel that allows it to be attached to standard harpoons used in stretched surfaces.

Mounting method:

The profile is assembled with the help of "FOLHAK" and hangers of suspended ceilings.

Additional information:

FOLED v-1 is intended for internal use.

Can be combined at any angle over 60 degrees.

The profile binding is connected to the plane of the film.

Easy connection via "ZM connectors".

The profile can be used with all products from the FOLED group.

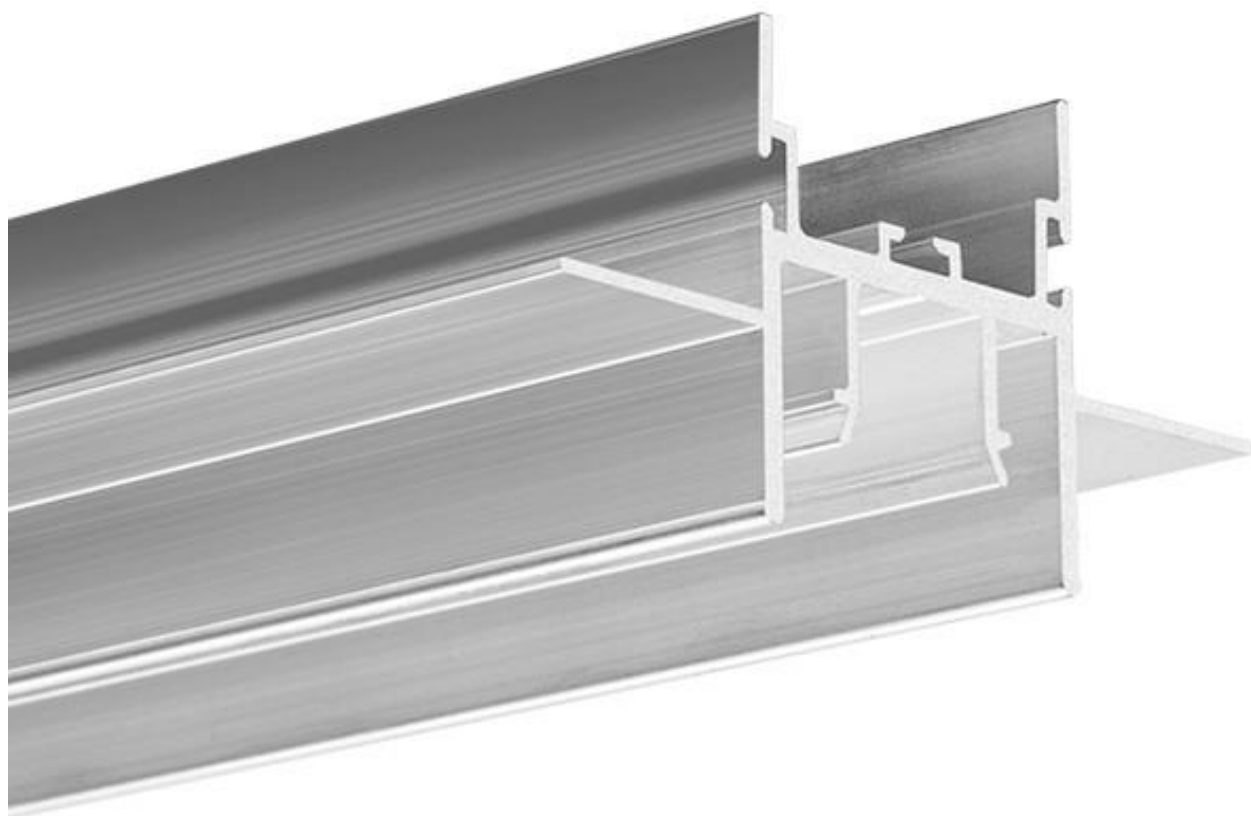

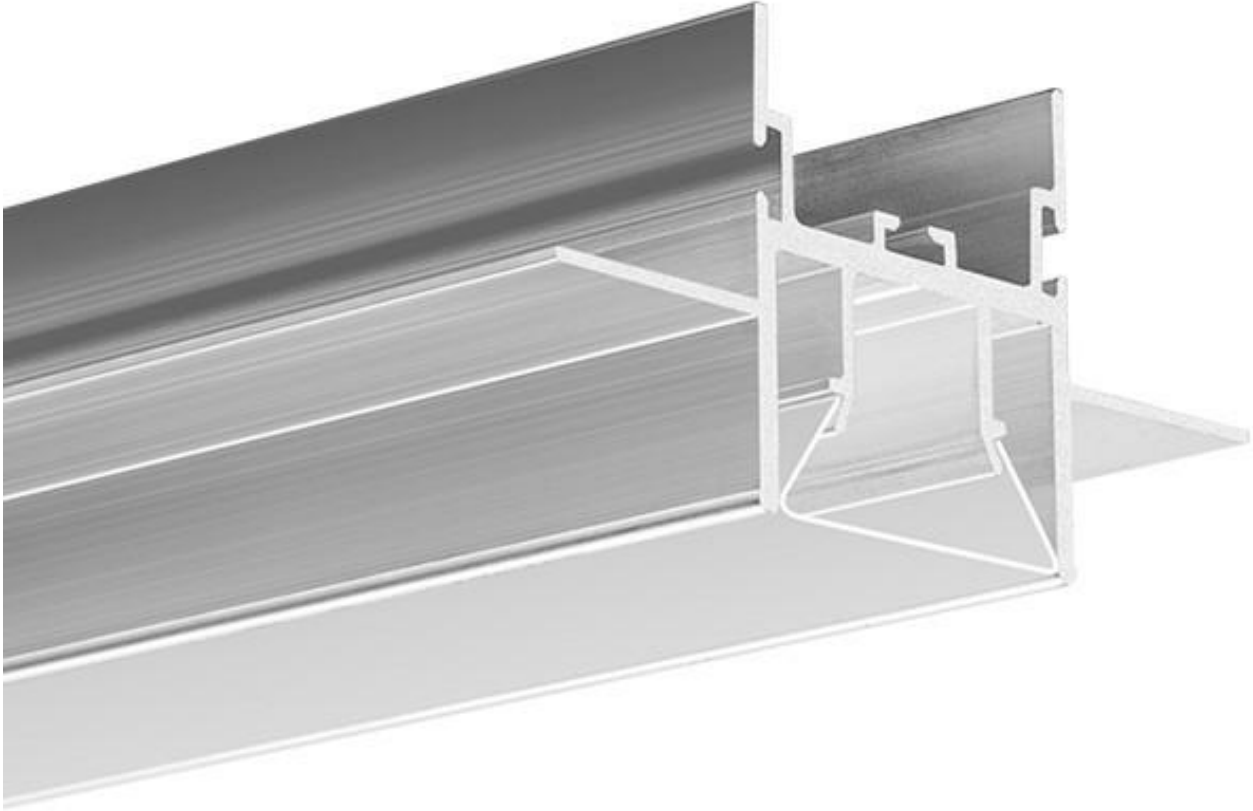





PRZYKŁADY MONTAŻU / MOUNTING EXAMPLES

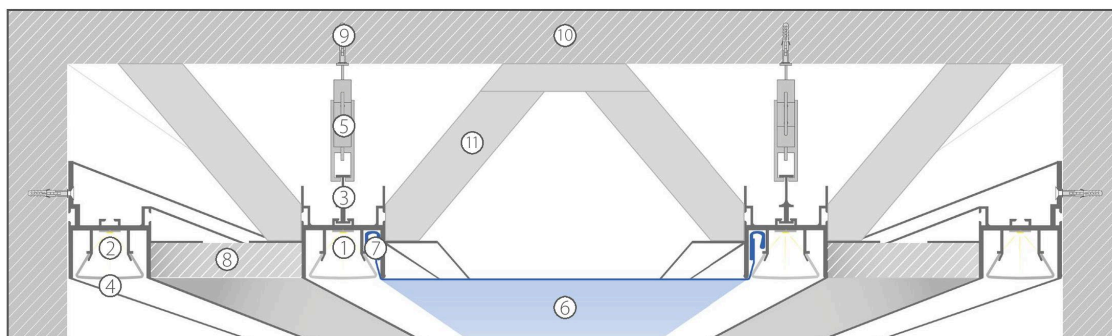

- ① FOLED
- ② FOLED-BOK
- ③ FOLHAK
- ④ osłona FOLED / cover FOLED
- ⑤ wieszak FOLED ze sprężyną / FOLED hanger with spring
- ⑥ folia sufitu napinanego / stretch ceiling foil

- ⑦ harpun sufitu napinanego / stretch ceiling hook
- ⑧ karton-gips / drywall
- ⑨ kołek do muru / wall plug
- ⑩ ściana / wall
- ⑪ wspornik / support

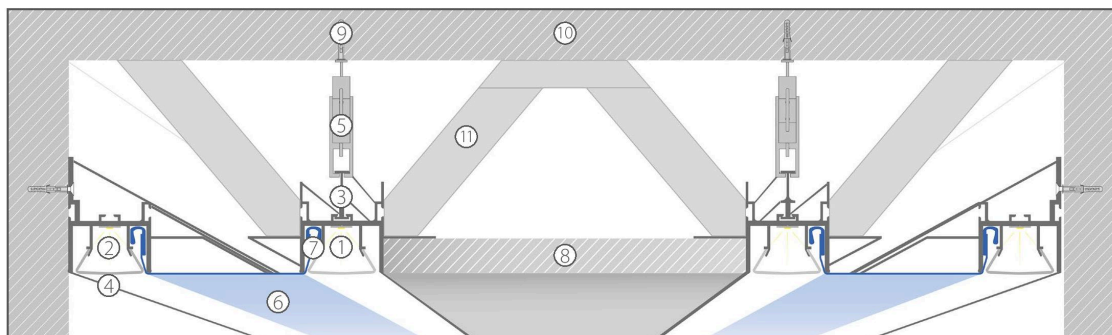

- ① FOLED
- ② FOLED-BOK
- ③ FOLHAK
- ④ osłona FOLED / cover FOLED
- ⑤ wieszak FOLED ze sprężyną / FOLED hanger with spring
- ⑥ folia sufitu napinanego / stretch ceiling foil

- ⑦ harpun sufitu napinanego / stretch ceiling hook
- ⑧ karton-gips / drywall
- ⑨ kołek do muru / wall plug
- ⑩ ściana / wall
- ⑪ wspornik / support

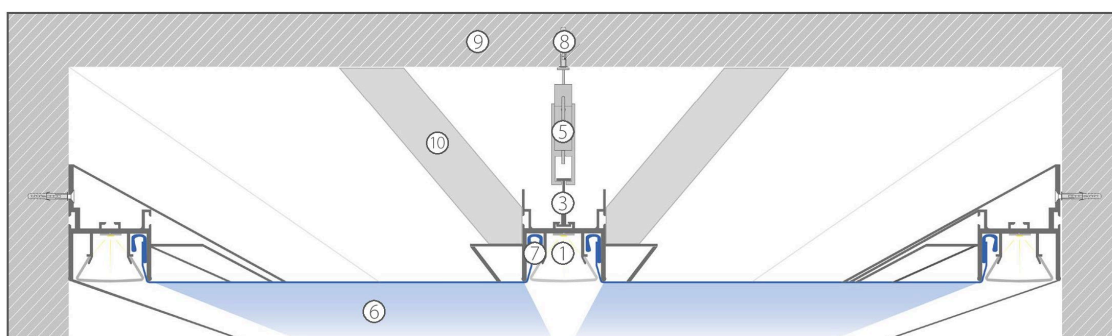

- ① FOLED
- ② FOLED-BOK
- ③ FOLHAK
- ④ osłona FOLED / cover FOLED
- ⑤ wieszak FOLED ze sprężyną / FOLED hanger with spring
- ⑥ folia sufitu napinanego / stretch ceiling foil

- ⑦ harpun sufitu napinanego / stretch ceiling hook
- ⑧ kołek do muru / wall plug
- ⑨ ściana / wall
- ⑩ wspornik / support

PRZYKŁADY MONTAŻU / MOUNTING EXAMPLES

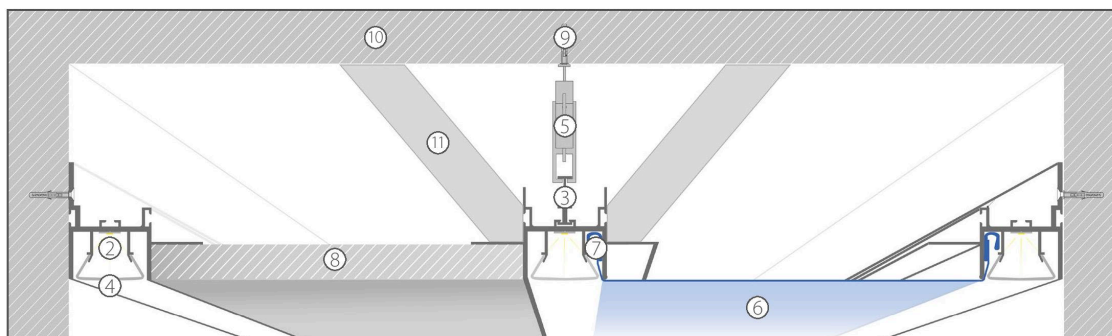

- ① FOLED
- ② FOLED-BOK
- ③ FOLHAK
- ④ osłona FOLED / cover FOLED
- ⑤ wieszak FOLED ze sprężyną / FOLED hanger with spring
- ⑥ folia sufitu napinanego / stretch ceiling foil
- ⑦ harpun sufitu napinanego / stretch ceiling hook
- ⑧ karton-gips / drywall
- ⑨ kołek do muru / wall plug
- ⑩ ściana / wall
- ⑪ wspornik / support

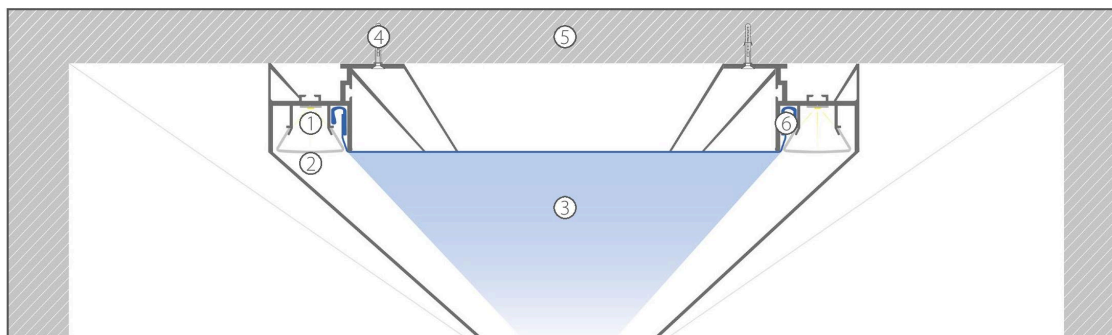

- ① FOLED-SUF
- ② osłona FOLED / cover FOLED
- ③ folia sufitu napinanego / stretch ceiling foil
- ④ kołek do muru / wall plug
- ⑤ ściana / wall
- ⑥ harpun sufitu napinanego / stretch ceiling hook

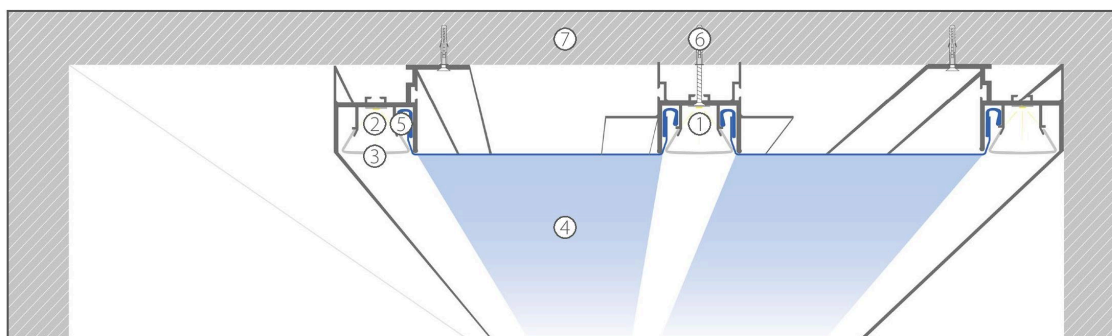

- ① FOLED
- ② FOLED-SUF
- ③ osłona FOLED / cover FOLED
- ④ folia sufitu napinanego / stretch ceiling foil
- ⑤ harpun sufitu napinanego / stretch ceiling hook
- ⑥ kołek do muru / wall plug
- ⑦ ściana / wall

